

ROCK ISLAND TECHNICAL SOCIETY

DATA SHEET

 NO.
C-001

ITEM

STEEL CABOOSSES

 DATE ISSUED
OCT 88

 ROCK ISLAND LINES
25'-0" ALL STEEL CABOOSE CARS

17830-17899

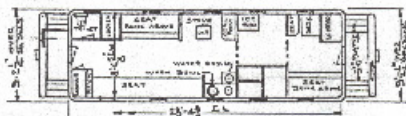
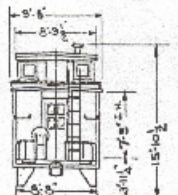
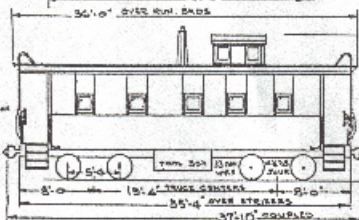
 INSIDE HEIGHT 7'-3"
 INSIDE WIDTH 6'-6"⁵/₈"
 INSIDE LENGTH 28'-4"⁷/₈"

 SOME CABOOSSES
 EQUIP WITH BATTERY BOX
 CHARGERS FOR USE
 WITH RADIO.

BUILT BY	RECO	1930
WEIGHT		46600 LBS
UNDERFRAME	ALL RIVETED 12" X 40" STEEL SILL	
SUPERSTRUCTURE		STEEL FRAMED
ROOF	WOOD COVERED WITH CANVAS	

RUN BOARD	WOOD
PLATFORM STEPS (STEP) PASS TYPE SAFETY TREADS	
HAND BRAKE	ADAX
BODY BRAKE	KC 101E WAB
DRAFT GEAR	A AK GERT 24" B PCKET
COUPLER	6 X 8 SHANK TYPE D ROTARY
COUPLER YOKE	AAR C-5 VEET KEY CONNECTED
COUPLER RELEASE	ROTARY

TRUCK	BETZ SWING MOTION
BOUNDRALS	2 1/2 X 8"
SIDE FRAME	CAST STEEL
BOLSTER	CAST STEEL
BRAKE BEAM	AAR #2
SIDE BEARING	ROLLER
SPRINGS	#82
WHEELS	33" DIA. E.I.

BODY WEIGHT	32120 LBS
TRUCK WEIGHT	14480 LBS

2-17-50

Rock Island's initial batch of steel sheathed cabooses were built by the railroad in 1930 to virtually the same dimensional specifications as their wood sheathed cars that had been built by various builders since 1903. The most unique feature of these cars was their silver paint scheme. In theory, they were supposed to be cooler inside. When the Farrington era came in, the cars were repainted to a more typical color scheme. Some cars may have lasted into the 40's with the silver, however. One car, 17899 received welded rather than riveted sides. This was a fairly typical Rock Island practice, to make one car of a batch something experimental to test the acceptability of a new concept. The cabooses were modernized in 1955 and most survived to the end of service. Several were sold to railfans and collectors around the midwest including 17864 to RITS member Arvid Hagberg. (Steve Hile)